

KIG-01 使用說明書

1. 產品內容清單

- | | | | |
|---------|-----|-------------------|-----|
| ① 本體 | 1PC | ③ 電源轉換器組 (KIC-04) | 1PC |
| ② 清潔用刷子 | 1PC | ④ 使用說明書 (本書) | 本冊 |

2. 產品用途說明

本靜電消除器 KIG-01 以電暈放電產生離子，使用氣壓氣流 (blow type) 將離子快速送達目標，可快速的去除靜電及灰塵，並可預防因靜電氣所造成的污染，能簡單的大幅提升產品的品質及生產良率。

3. 特點與優點

- ① 體積小、重量輕、有效降低長時間手持使用的疲勞負荷。
- ② 高周波交流放電，離子綿密可深入凹凸處，確實去除靜電。
- ③ 高精度離子平衡 $\pm 10V$ 以下。(使用標準噴嘴 KIB-N01S)
- ④ 配備流量調節閥，可依需求調節適合的流量，節省氣壓損耗量。
- ⑤ 放電異常時，警示燈輸出，若產品故障時可以有效確認。
- ⑥ 可依據現場實際狀況，選購適當的空氣噴嘴，使用非常方便。

-1-

4. 外型尺寸

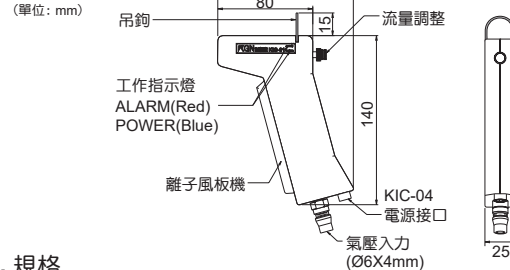

5. 規格

| | | KIG-01 |
|-----------------|-----------------------------|-----------------------------------|
| 使用流體 | | 乾淨壓縮空氣 |
| 放電針電壓施加方式 | | 高頻AC (約)2KV, 100KHz |
| 入力電源 | | DC 24V \pm 5% |
| 容量 | | 3VA (0.1A) |
| 消耗電流 | | (約)100 mA |
| 離子平衡* | | $\pm 10 V$ |
| LED動作指示燈 | 電源 | 綠燈 |
| | 異常 | 紅燈 |
| 臭氣量 | (以下) | 0.04 ppm |
| 空氣流量 | (最大值) | 160l/min (6 kgf/cm ²) |
| 使用壓力範圍 | | 0.05~0.6 MPa |
| | | 0.5~6.0 kgf/cm ² |
| 使用環境溫度 | | 0~40°C (室內) |
| 外型尺寸(本體)(WxDxH) | | 115X140X25 mm |
| 重量(本體) | | 220 g |
| 標準配件 | 電源轉換器組(KIC-04) (AC100~240V) | 388 g |
| | 放電針清潔刷 | 1.4 g |
| | 懸掛吊鉤 | 0.7 g |

*1. 離噴嘴出口處150mm。

-2-

6. 使用方法

- ① KIG-01 本體上固定好選購的噴嘴，接上電源轉換器組 (KIC-04) 及空氣壓配管。
- ② 通過過濾器之乾淨空氣 (由貴社提供)，並可以預先調整節流閥的流量限制，插入 KIG-01 的入氣接頭。
- ③ 壓下把手就可以打開電源以及空氣噴出，空氣大小由壓下角度決定。
- ④ 要消除靜電及灰塵的對象，放在出風口前方，即可有效除去目標物上的靜電以及灰塵。
- ⑤ 放電針一段時間後，因濕氣會產生結晶，請使用小刷子清潔針尖。針尖若有積炭或髒污，可用棉花棒或軟布沾酒精，擦拭針尖。
- ⑥ 建議經常清潔放電針，延長針的使用壽命，維持良好的離子平衡及除電效果。(在良好維護的情形下，使用約10,000小時請更換放電針)
- ⑦ 若紅色LED燈亮，表示放電異常，請聯絡服務人員，切勿自行拆解。

7. 維護

- ① 拔除電源 ➡ 移除空壓管 ➡ 拆掉噴嘴頭 ➡ 棉花棒沾酒精清潔

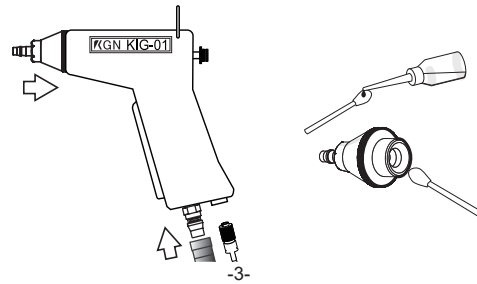

-3-

- ② 清潔並去除放電針上的結晶物；再使用清潔刷，確認放電針有無異物附着

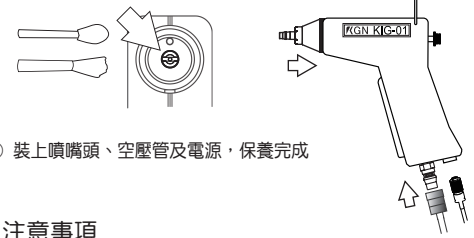

8. 注意事項

| | |
|---|---|
| ⚠ | 避免使用於有水氣、油氣、灰塵、高溫、多濕的場所。嚴禁於爆炸性、易燃性氣體，及需要防爆的場合使用本產品。 |
| ⚠ | 嚴禁拆解：內部迴路及放電針高電壓危險，勿自行拆解本產品。 |
| ⚠ | KIG-01 不可單獨使用，須在加裝空氣噴嘴。 |
| ⚠ | 清潔放電針，務必拔掉電源，並且小心避免被尖端刺傷。 |
| ⚠ | 通電中不可拆下空氣噴嘴，避免高電壓觸電危險。 |
| ⚠ | 禁止於未供給氣源狀態下啟動放電。 |
| ⚠ | 觸電危險：◎ 通電中不要觸摸放電針 ◎ 實施配線、保養或維修，請拔除電源 |

-4-

KIG-01 Instruction Manual

1. Product list

- | | | | |
|------------------|-----|-------------------------|------|
| ① Body | 1PC | ③ Power adapter(KIC-04) | 1PC |
| ② Cleaning brush | 1PC | ④ Instruction manual | This |

2. Applications of this product

This static eliminator (Model No. KIG-01) produces ions through Corona Discharge, which are sent to the destination in a timely manner using the blow type method. The model is capable of rapidly eliminating static and dust as well as preventing the pollution caused by static currents. It can easily but vastly improve product quality and production yield.

3. Features and advantages

- ① Small volume, light weight, to reduce the tiredness of long time hand carry.
- ② High frequency AC discharge, high density ion capable of infiltrating into cavities, hence thoroughly eliminating static electricity.
- ③ High accuracy ion balance to lower than $\pm 10V$. (Use standard KIB-N01S discharge nozzle)
- ④ Equipped with a Flow Rate Regulating Valve to adjust suitable flow rate as required, so as to conserve the air consumption.
- ⑤ When abnormal discharge occurs, there will be warning light and contact point output for effective monitoring and control.
- ⑥ Optional purchase of suitable air discharge nozzle according to actual requirement for your convenience.

-5-

4. Dimensions

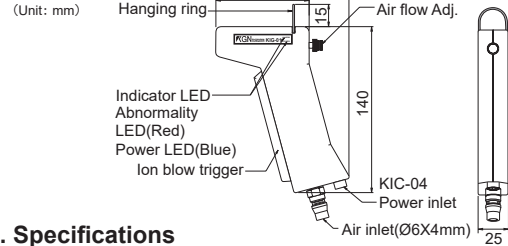

5. Specifications

| | | KIG-01 |
|-------------------------------------|-----------------------------------|---|
| Media | | Air (Non-lubricated dry air) |
| Voltage at discharging pin | | High-frequency AC Approximate 2KV, 100KHz |
| Power Input | | DC 24V \pm 5% |
| Capacity | | 3VA (0.1A) |
| Current Consumption | | Approximate 100 mA |
| Ion Balance* | | $\pm 10 V$ |
| Indicator LED | Power Supply | LED (Green) |
| | Abnormality | LED (Red) |
| Ozone volume (or less) | | 0.04 ppm |
| Supply Air Flow Range (Max.) | | 160l/min (6 kgf/cm ²) |
| Operating Air Pressure Range | | 0.05~0.6 MPa |
| | | 0.5~6.0 kgf/cm ² |
| Operating Environmental Temperature | | 0~40°C (indoor) |
| Overall Dimensions (Main Unit) | | (WxDxH) 115X140X25 mm |
| Weight (Main Unit) | | 220 g |
| Accessories | Power adapter (KIC-04) AC100~240V | 388 g |
| | Clean brush | 1.4 g |
| | Hanging ring | 0.7 g |
| | | |

*1. 150mm away for the nozzle outlet.

-6-

6. Operation

- ① Secure the main body of Model KIG-01 and the is charge nozzle.
- ② A filter is provided for the clean air (to be provided by your company). Further, the limitation of the flow rate of Throttle Valve may be adjusted in advance for inserting the KIG-01 Intake Connector.
- ③ Push the handle to turn on the power source and to spray air, and the air volume will be determined according to the pressing angle.
- ④ To eliminate electrostatic and dust, mount the unit in front of an air outlet, and the electrostatic and dust can be removed from the target effectively.
- ⑤ After a certain period of operation, crystallite will generate on the discharge needle because of moisture, please use a brush to clean up the needle point.
- ⑥ It is suggested that the discharge needle be cleaned regularly to prolong the needle's service life and to maintain good ion balance and static electricity limitation effects. (Replace the discharge needle after 10,000 hours of use provided regular maintenance has been done.)
- ⑦ If the red LED light is on, this means abnormal discharge is taking place. Please contact our service staff. Do not try to disassemble the unit by yourself.

7. Maintenance

- ① Unplug the power ➡ Remove the tube ➡ Remove the nozzle
➡ Use a cotton wool with alcohol to clean the needle

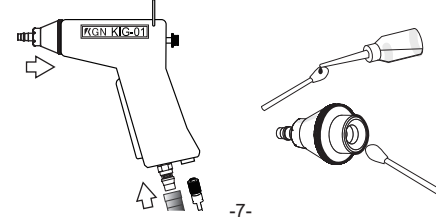

-7-

- ② Clean and remove any crystals from the needle, and then use a Static Brush to confirm if foreign matter is affixed to the needle.

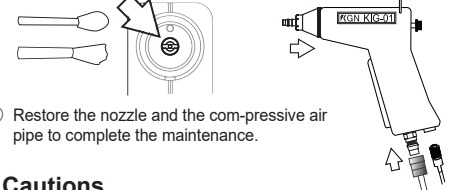

8. Cautions

| | |
|---|---|
| ⚠ | Installation location: Try to avoid locations with abundant of steam, oil vapor, dust, and high temperature and high humidity. This product shall not be used at locations where explosion-proof is required. |
| ⚠ | Disassembling is prohibited: High voltage danger exists within the internal circuit and the discharge needle. Do not disassemble this product by yourself. |
| ⚠ | This model KIG-01 shall not be used alone but in conjunction with the air discharge nozzle, which shall be installed at the front of the body. |
| ⚠ | Make sure that the power is off when replacing or cleaning the discharge needle and be careful not to be stung by the needle to be pricked. |
| ⚠ | Do not disassemble the air discharge nozzle when the power is on to avoid high voltage danger. |
| ⚠ | When in use, it is prohibited to operate continuously in a state where no gas source is supplied. |
| ⚠ | Electric Shock Danger ◎ Never touch the discharge needle when energized ◎ Switch off power before going ahead with service or maintenance |

-8-

201804